

USERS INFORMATION MANUAL

MODULAR AIR HANDLER WITH ELECTRIC OR HOT WATER HEATING

MODELS: MM SERIES

For Installation In:

- 1. Modular Homes & Buildings**
- 2. Residential Homes**

LIST OF SECTIONS – USERS INFORMATION MANUAL

1 – General	1	4 – Start Up & Shutdown Instructions	5
2 – Safety	2	5 – Owner Maintenance	5
3 – Owners Information & Seasonal Information	3		

LIST OF SECTIONS – SERVICE AND MAINTENANCE MANUAL

1 – Safety	7	6 – Blower Performance	13
2 – Air Handler Maintenance	8	7 – ECM Control Board Climate Profiles	16
3 – Air Handler Controls	9	8 – Accessories Parts	17
4 – Sequence of Operation	9	9 – Replacement Parts	17
5 – Troubleshooting	10		

LIST OF FIGURES

1 – Air Handler Examination Check Points	4	12 – Motor Speed Tap Isolation Relay - X-13 and PSC Motors	10
2 – Home Owner / Users Cleaning Points	5	13 – ECM Motor Control Pin Out	11
3 – Accessory Air Filter Box – Upflow	6	14 – X-13 Motor Terminals	11
4 – Accessory Filter Box – Adjustment for 1” and 2” Filters	6	15 – Blower Mounting Plate and Screw Locations	12
5 – Downflow / Horizontal Filter Location – Wall or Ceiling	6	16 – ECM Control Board Diagram	15
6 – Hydronic Heat Control Box with Pump	8	17 – ECM Climate Profiles figure 1	16
7 – Hydronic Heat Control Box – No Pump	8	18 – ECM Climate Profiles figure 2	16
8 – Blower Assembly and Mounting Screw Location	8	19 – MM**OS Hydronic Heat Replacement Parts Drawing	17
9 – ICM AY1015 Hydronic Control Board for C.T. & ECM Motors	9	20 – MM**OM Hydronic Heat Replacement Parts Drawing	18
10 – ICM AY1014 Hydronic Control Board for PSC Blower Motors	9	21 – MM**OL Hydronic Heat Replacement Parts Drawing	19
11 – Component Locations – Hydronic Heat Models	9		

LIST OF TABLES

1 – X-13 Motor Terminal Connections	11	8 – MMPS Blower Performance - CFM Data – PSC Motor	14
2 – 208 / 240 VAC Blower Motor Current Chart	11	9 – MMPS Blower Performance - Amp Data – PSC Motor	14
3 – 120 VAC Blower Motor Current Chart	11	10 – Blower CFM - Heat & Cool Jumper Pin Taps ECM Cntrl Board	15
4 – MMVE Blower Performance – CFM Data - ECM Motor	13	11 – MSVE, MSVT, MSPS Accessory Parts List	17
5 – MMVE Blower Performance - Amp Data - ECM Motor	13	12 – MS 18-24 Hydronic Heat Replacement Parts List	17
6 – MMVT Blower Performance – CFM Data - X-13 Motor	13	13 – MS 25-30-36 Hydronic Heat Replacement Parts List	18
7 – MMVT Blower Performance - Amp Data – X-13 Motor	14	14 – MS 37-42-48-60-72 Hydronic Heat Replacement Parts List	19

CONTACT INFORMATION

Contact us by mail: Manufactured and Distributed by

Mortex Products Inc.
501 Terminal Rd
Fort Worth, TX 76106

www.mortx.com

SECTION I: GENERAL

The following list includes important facts and information regarding the air handler and its inclusions.

1. Air Handler is rated at 240 volts AC at 60 Hertz for electric heat models or 120 volts AC at 60 Hertz for hydronic models.
2. Air Handler is available in a small, medium, or large cabinet size.
3. All air handlers are equipped with a blower for A/C or Heat Pump operation.
4. Multi-position models are designed for upflow, downflow and horizontal application. All other models are designed for upflow and horizontal application.
5. This air handler must not be operated without the doors installed.

NOTE: This air handler and its components are listed as a combination AC or Heat Pump system by ETL for sale in the United States and Canada.

▲ WARNING

FIRE OR ELECTRICAL HAZARD

Failure to follow the safety warnings exactly could result in serious injury, death, or property damage. A fire or electrical hazard may result causing property damage, personal injury or loss of life.

Do not store or use gasoline or other flammable vapors and

USERS MUST READ ALL INSTRUCTIONS IN THIS MANUAL AND THIS MANUAL MUST BE SAVED FOR FUTURE REFERENCE

SECTION II: SAFETY



This is a safety alert symbol. When you see this symbol on labels or in manuals; be alert to the potential for personal injury.

Understand and pay particular attention to the signal words **DANGER**, **WARNING**, or **CAUTION**.

DANGER: indicates an **imminently** hazardous situation, which if not avoided, **will result in death or serious injury.**

WARNING: indicates a **potentially** hazardous situation, which if not avoided, **could result in death or serious injury.**

CAUTION: indicated a **potentially** hazardous situation, which if not avoided, **may result in minor or moderate injury.** It is also used to alert against unsafe practices and hazards involving property damage.

WARNING

Any adjustment, service or maintenance by the home owner and/or user may create a condition where the operation of the product could cause personal injury or property damage.

Only qualified service personnel, a contractor, or an installer may refer to the service and maintenance section of this manual for assistance or for additional information on this appliance.

CAUTION

This product requires periodic routine maintenance and cleaning of the exterior surfaces by the homeowner or user to remove dust and debris. Any additional service must be performed by qualified personnel. This appliance must be serviced and maintained as specified in these instructions and/or to any applicable local, state, and national codes including, but not limited to building, electrical, and mechanical codes.

WARNING

FIRE OR ELECTRICAL HAZARD

Failure to follow the safety warnings exactly could result in serious injury, death, or property damage.
A fire or electrical hazard may result causing property damage, personal injury or loss of life.

SAFETY REQUIREMENTS

1. This air handler must be kept clear and free of combustible materials, gasoline and other flammable vapors and liquids.
2. Insulating materials may be combustible. The air handler must be kept free and clear of insulating materials. The air handler area must be examined when installed in an insulated space or when insulation is added to be sure that the insulation material has been kept away from the appliance.
3. Follow the instructions exactly as shown in Startup and Shutdown Section in this manual to properly Startup or Shutdown this appliance.
4. If overheating occurs, turn off the power to the appliance and contact a qualified contractor, installer, or service agency.

DANGER

Do not use this appliance if any part has been under water. A flood damaged furnace is extremely dangerous. Attempts to use the air handler can result in a fire.
A qualified contractor, installer, or service agency must be contacted to inspect the air handler for any water damage and replace all components, control system parts, or electrical parts that have been damaged. If enough damage is present, the air handler may need to be replaced.

5. NEVER - Store flammable materials of any kind near your appliance. Gasoline, solvents and other volatile liquids should be stored only in approved containers outside the home. These materials vaporize easily and are extremely dangerous.
6. NEVER – Store cleaning materials such as bleaches, detergents, powder cleaners, etc. near the appliance. These chemicals can cause corrosion of the air handler sheet metal and the electric heaters, the blower and the electrical controls.
7. NEVER – Use the area around the appliance as a storage area for items which could block or obstruct the normal air flow to the air handler or the space around the appliance. The flow of air is required for safe and proper operation. Never block or obstruct air openings used for ventilation and cooling of the air handler electrical components.
8. Refer to the appliance rating plate for the air handler model number, for the operating specifications for safe operation.
9. Provide clearances for servicing ensuring service access is allowed for the control box, electric elements and the blower.
10. Failure to carefully read and follow all instructions in this manual can result in malfunction of the air handler, death, personal injury, and/or property damage.
11. If the air handler is installed in a residential garage it must be installed so that the electric heaters are located not less than 18 inches above the floor and the air handler must be

located or protected to avoid physical damage by vehicles.

▲WARNING

FIRE OR ELECTRICAL HAZARD

Servicing heating/cooling equipment can be hazardous due to electrical components.

Only trained and qualified personnel can service or repair heating/cooling equipment. The home owner **must never** try to perform service, repair or maintenance on this appliance.

Untrained service personnel can perform only basic maintenance functions such as cleaning of exterior surfaces and replacing the air filters.

Observe all precautions in the manuals and on the attached labels when working on this appliance

12. These instructions cover minimum requirements and conform to existing national standards and safety codes. In some instances these instructions exceed certain local codes and ordinances, especially those who have not kept up with changing modular home and residential home construction practices. These instructions are to be followed and are the minimum requirement to perform service or repairs on this appliance.

SECTION III: OWNERS INFORMATION AND SEASONAL INFORMATION

How The Air Handler Works – Heating Cycle

The appliance is equipped with the controls necessary for proper and safe operation. Circuit breaker location is shown in Figure 1.

The air handler is equipped with a relay(s), time delay relay, transformer, circuit breakers (Electric Heat Models Only), and a blower assembly. The transformer provides 24 VAC to the thermostat.

When the thermostat calls for heat on the electric heat models, the relay(s) energize sending 240 VAC thru the limit switches to the electric heaters causing them to get hot. The indoor fan motor is then energized on the selected heating speed tap after an "ON" time delay and the circulating blower draws cool air from the living space(s), passes it across the heater coils and circulates the warmed air through the duct work to the living space(s). When the thermostat is satisfied the electric heaters are de-energized. The blower is also de-energized after an "OFF" time delay and the heating cycle has ended and the air handler is ready for the next call for heat to start the next cycle.

When the thermostat calls for heat on the hydronic heating models a pump relay will be energized causing the flow of hot water thru the hot water coil, heating the coil. The indoor fan motor is energized on the heating speed tap after an "ON" time delay. The circulating blower then draws cool air from the living space(s), passes it across the hot water coil and circulates the warmed air through the duct work to the living

space(s). When the thermostat is satisfied the circulating pump is de-energized. The blower is also de-energized after an "OFF" time delay, the heating cycle has ended and the air handler is ready for the next call for heat to start the next cycle.

How The Air Handler Works – Cooling Cycle

When the thermostat calls for cooling, 24 VAC is sent to the compressor contactor causing it to close energizing the compressor and the outdoor fan motor. The indoor fan motor is then energized on the selected cooling speed tap after an "ON" time delay and the circulating blower draws air from the living space(s), passes it across the cooling coil in the air handler and circulates the cooled air through the duct work to the living space(s). When the thermostat is satisfied the compressor contactor is de-energized turning off the compressor and the outdoor fan motor. The blower is also de-energized after an "OFF" time delay and the cooling cycle has ended and the air handler is ready for the next call for cooling to start the next cycle.

When the thermostat calls for heat pump, 24 VAC is sent to the compressor contactor causing it to close energizing the compressor and the outdoor fan motor. The reversing valve is energized causing the flow of the refrigerant to reverse and heat the coil inside the air handler. The indoor fan motor is then energized on the selected heat pump speed tap after an "ON" time delay and the circulating blower draws air from the living space(s), passes it across the coil in the air handler and circulates the warmed air through the duct work to the living space(s). When the thermostat is satisfied the compressor contactor is de-energized turning off the compressor and the outdoor fan motor. The blower is also de-energized after an "OFF" time delay and the heat pump cycle has ended and the air handler is ready for the next call for heat pump to start the next cycle.

Examination of the air handler

The home owner should perform a visual examine the furnace every month for any defects or problems. The items to be inspected are:

1. The physical support of the furnace is sound without sagging cracks, gaps, etc. around the base so as to provide a seal between the support and the base.
2. The furnace casing for any obvious signs of deterioration from rust or corrosion.
3. The return and supply duct connections are physically sound and are sealed to the furnace casing.
4. The furnace must be serviced by qualified personnel annually, preferably at the start of each heating season.

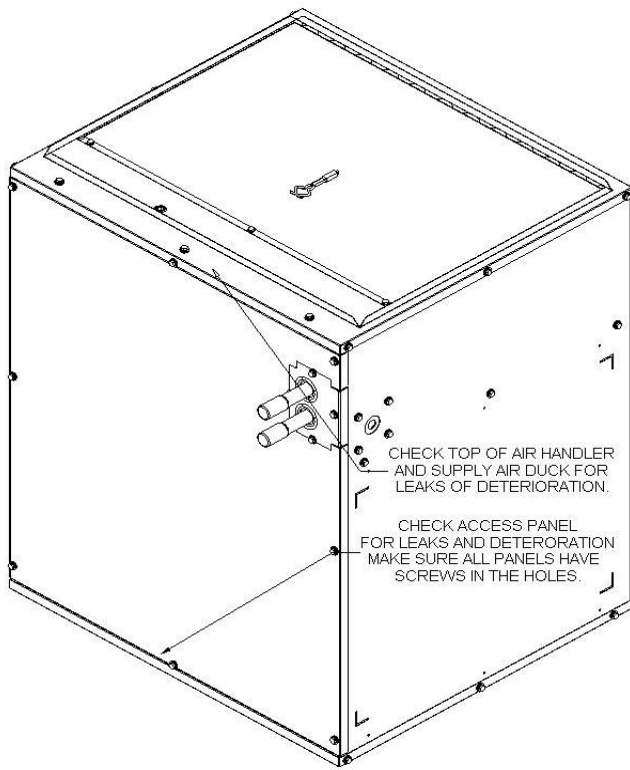

Figure 1: Air Handler Visual Check Points

The Service Technician

The air handler's best friend is a qualified service technician. If the appliance gives any indication of improper operation, call the service technician. The service technician is allowed to perform the normal routine care of your appliance. He can detect potential problems and make corrections before trouble develops. Preventative maintenance of this type will allow the air handler to operate with minimal concerns to the homeowner and will add years of comfort.

Warranty and Responsibilities

It is the sole responsibility of the homeowner to make certain the furnace has been properly installed and adjusted to operate properly.

The manufacturer warrants the appliance to be free from defects in material or workmanship for a stated time in the warranty agreement. The manufacturer will not be responsible for any repair costs to correct problems due to improper setup, improper installation, improper furnace adjustments, installing parts or components on the appliance that are not listed for use with this appliance, improper operating procedures by the user or repairs performed by the appliance user or owner.

Some specific examples of service calls which will be excluded from warranty reimbursement are:

1. Correcting faulty duct work in the home. This can be due to not enough ducts or ducts are too small to provide proper air flow through the air handler.
2. Correcting electrical wiring problems in the supply wiring to the air handler.
3. Resetting circuit breakers or on/off switches used for servicing.

4. Problems caused by installation and operation of any air conditioning unit, heat pump, or other air quality device which is not approved for use with this air handler.
5. Adjusting or calibrating the thermostat.
6. Problems caused by construction debris which has fallen into the air handler.
7. Replacement of fuses.
8. Problems caused by dirty air filters.
9. Problems caused by restrictions in the return or supply air flow causing low air flow.

The home owner should establish a firm understanding of these responsibilities with the installer or Service Company so there will be no misunderstanding of what will be covered under warranty at a later date.

While you are away

The air handler is equipped with safety shutoff devices which are designed to prevent the appliance from overheating in case of a malfunction. For this reason it is never practical to assume the appliance will operate unattended for a long period of time. An example of a malfunction that can cause significant damage to the home would be:

If the blower motor fails the heaters will cycle on the safety shutoff devices while the temperature inside your home continues to drop. All of the water pipes will freeze once the temperature falls below 32°F.

If you are planning to be away from home for a long period of time, have someone check on your home everyday, especially when the outside temperatures will be below 35°F to ensure the air handler is operating properly. This may prevent water pipes from freezing.

The Furnace Fails to Operate Properly

If any abnormalities are observed while the furnace is operating normally, perform the following checks:

1. Check the setting on the thermostat to make sure the thermostat is set above the room temperature.
2. Check to see if the electrical power is turned on at the circuit breakers at the main service circuit breaker box or check any on/off switches that may be used for service disconnect switches.
3. Check any inline fuses that may have been installed on the air handler to determine if it has blown.
4. Make sure the air filters are clean, return grilles clean, are not obstructed, and supply air registers are open.

If the cause of the malfunction is not obvious do not attempt to service the appliance yourself. Call a qualified service agency/company to repair the appliance.

When to Call For Service Assistance

Very often time can be saved if you give a service agency the information about the air handler ahead of time. This will enable the service agency to determine the specific components used and possibly indentify the problem, thus arriving with the parts to fix the problem. Write down the model number, Serial Number and be prepared to describe what the air handler is or is not doing and what you have checked prior to calling.

SERVICE AGENCY INFORMATION

Fill in Below

MODEL NUMBER: _____

SERIAL NUMBER: _____

SERVICE COMPANY: _____

ADDRESS: _____

TELEPHONE (DAYTIME): _____

TELEPHONE (EMERGENCY) _____

NOTES: _____

SECTION IV: STARTUP AND SHUTDOWN INSTRUCTIONS

Read the instructions below before trying to start the appliance.

WARNING

If you do not follow these instructions exactly, a fire may result causing property damage, personal injury, and/or loss of life.

- A. **BEFORE OPERATING;** check around perimeter of the furnace to make sure there are no flammable materials in the area. If you smell vapors of any kind, **DO NOT** turn on the power to the appliance until vapors have been ventilated and removed from the area of the appliance.
- B. **CHECK THE FURNACE;** visually check the appliance for loose screws and/or panels that may be missing or have fallen off.
- C. **CHECK DUCT CONNECTIONS;** visually check the connections of the ducts to the appliance to make sure there are no gaps or holes and ducts are securely fastened to the furnace.

Turn On / Start the Appliance

1. **STOP!** Read the safety information above before proceeding.
2. Set the thermostat to the lowest setting.
3. Turn off all electrical power to the appliance at the main service disconnect box.
4. Remove the upper and lower access door.
5. Turn off the circuit breakers on the appliance control box.
6. Remove the control box cover.
7. Visually check the control box for loose wire connections and faulty or loose components.
8. Visually check the blower compartment for obstructions or loose debris.
9. Replace the control box cover.
10. Turn the circuit breakers to the on position.
11. Replace the upper and lower access door.

12. Turn the circuit breakers in the main service disconnect box to the on position.
13. Set the thermostat to the desired setting.

Shutting Down or Turning Off the Appliance

1. Set the thermostat to the lowest setting.
2. Turn off all electrical power to the appliance at the main service disconnect box.
3. Remove the upper access door.
4. Turn off the circuit breakers on the appliance control box.
5. Replace the upper access door.

SECTION V: OWNER MAINTENANCE

All appliances need annual maintenance in order to operate properly. The annual service must be performed by qualified service personnel. The homeowner is expected to perform general cleaning of the exterior surfaces and replacement of the air filters. Air filters must be checked every month and replaced as needed. Figures 2 and 3 indicate the location of the air filters.

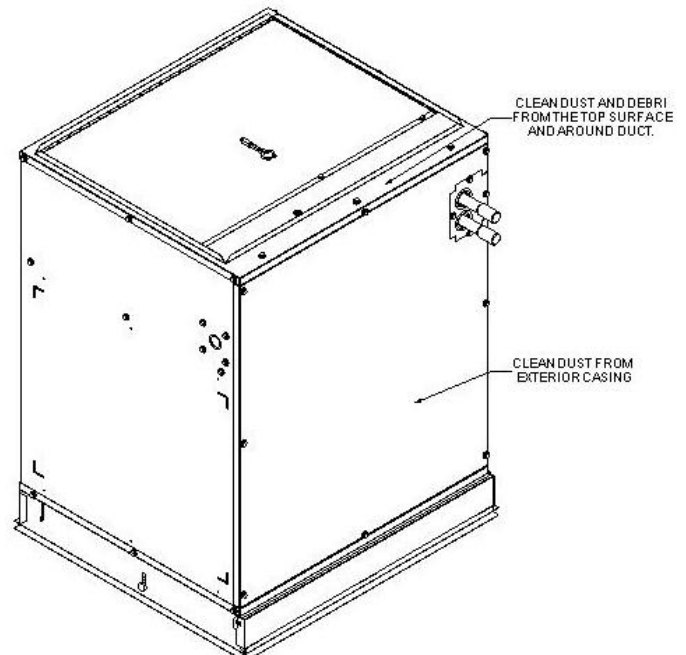

Figure 2: Home Owner / Users Cleaning Points

Upflow Air Filter Replacement – Accessory Filter Box Kit

Follow these easy steps to replace the air filters.

1. Follow the procedure **“To Turn Off the Appliance”** in the Startup and Shutdown Instructions section of these instructions.
2. Remove the white handled thumb screws on the front of the accessory filter box kit located at the return air end of the appliance.
3. Let the top of the door fall towards you then push down towards the floor.
4. Remove the air filter. The air filter is a disposable filter. **DO NOT** attempt to clean the filter and reuse it.
5. Check the size of the air filter that was removed to make sure it is replaced with a filter that is the same size.
6. Clean any access dirt or debris around the front area where the air filter is located. Be careful not to use any small vacuum cleaner parts or any small brushes to clean

inside the filter box, around the filter track. These parts or brushes can fall off or drop into the return duct causing a restriction of the return air flow.

7. Slide the air filter into the filter rack, push the door closed and tighten the thumb screw.
8. Follow the **“Turn On / Start the Appliance”** in the Startup and Shutdown Instructions section of these instructions.

NOTE: Make sure the flow arrows on the air filter are pointing towards the coil.

Accessory filter box kit can be used on the return air end of the air handler when configured in the downflow position in place of a wall, door or ceiling mounted return filter grille.

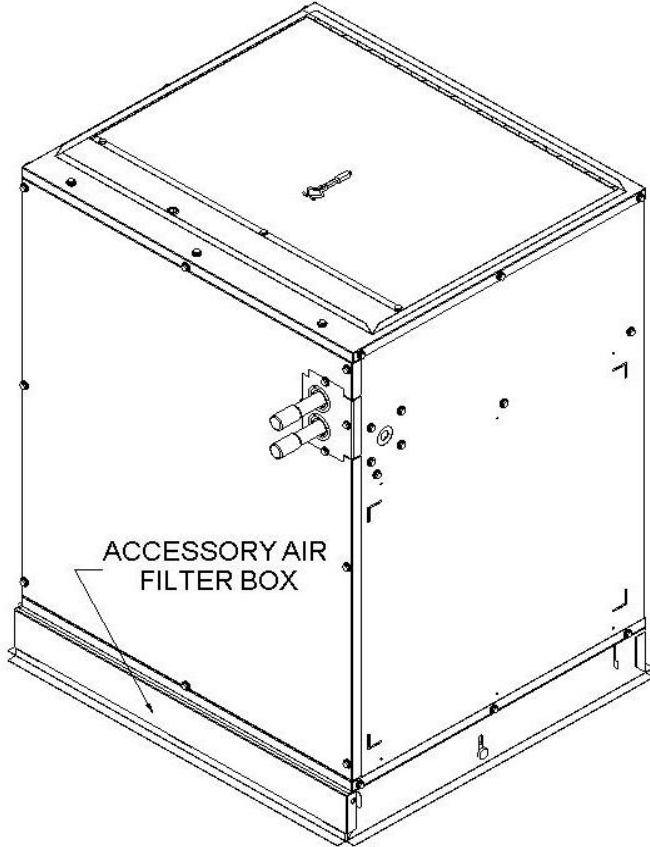

Figure 3: Accessory Air Filter Box

NOTE: Make sure the flow arrow on the air filter is pointing towards the coil.

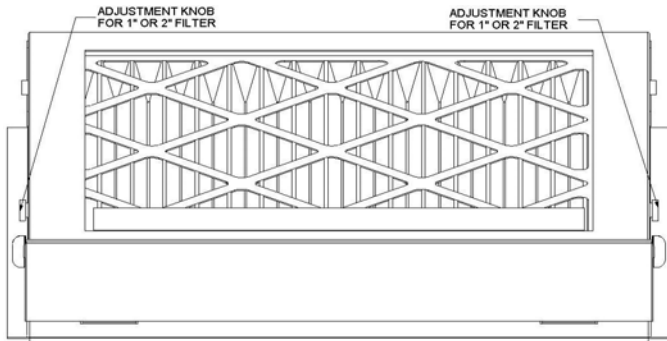

Figure 4: Accessory Air Filter Box – 1” or 2” Air Filter Adjustment knob. A knob is on both sides.
Downflow / Horizontal Air Filter Replacement

Appliances that are installed in a downflow or horizontal position generally have the filters in filter grilles located in the ceiling or the wall next to the ceiling. Follow these easy steps to replace the air filters.

1. Follow the procedure **“To Turn Off the Appliance”** in the Startup and Shutdown Instructions section of these instructions.
2. Remove the white handled thumb screw on the front of the filter grille or pull down on the latches on each side of the grille door to release the door from the grille assembly.
9. Let the grille door fall towards you, then, just let it hang.
10. Remove the air filter. If the air filter is a disposable filter DO NOT attempt to clean the filter and reuse it.
11. Check the size of the air filter that was removed to make sure it is replaced with a filter that is the same size.
12. Clean any dust or debris from both sides for the louvers and around the area where the filter is placed before the new air filter are installed.
13. Place the new air filter back into the grille assembly, push the grille door closed and tighten the thumb screw or push the latches in on each side of the door until the door is securely fastened to the grille assembly.
14. Follow the **“Turn On / Start the Appliance”** in the Startup and Shutdown Instructions section of these instructions.

NOTE: Make sure the flow arrows on the air filter are pointing away from the grille door.

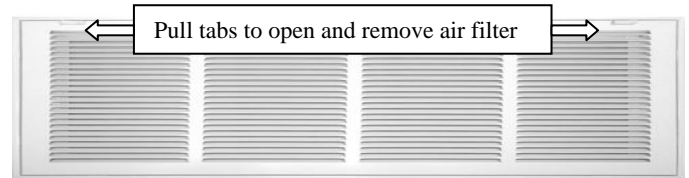

Figure 5: Downflow / Horizontal Air Filter Location – Wall or Ceiling

SERVICE AND MAINTENANCE MANUAL

SECTION I: SAFETY

THE HOME OWNERS AND / OR APPLIANCE USERS MUST STOP HERE!

This section has been designed to assist a **qualified service agency** in performing service and maintenance on this appliance.

The homeowners and/or the appliance user must never attempt to perform any service or maintenance on the appliance especially when it involves the removal or adjustment of any parts and/or components.

WARNING

The manufacturer or distributor will not be responsible for any repairs due to removal of parts or improper parts changes, improper maintenance, improper adjustments or improper modifications to this air handler that were performed by the homeowner and/or the appliance user.

The manufacturer will not be responsible if the homeowner and/or appliance user use this section of the instructions in an attempt to perform maintenance or repairs to the furnace. This practice is very dangerous and may result in a fire causing property damage, personal injury, loss of life and/or will void the appliance warranty.

The following safety rules must be followed when servicing this furnace.



This is a safety alert symbol. When you see this symbol on labels or in manuals; be alert to the potential for personal injury.

Understand and pay particular attention to the signal words **DANGER, WARNING, or CAUTION.**

DANGER: indicates an **imminently** hazardous situation, which if not avoided, **will result in death or serious injury.**

WARNING: indicates a **potentially** hazardous situation, which if not avoided, **could result in death or serious injury.**

CAUTION: indicated a **potentially** hazardous situation, which if not avoided, **may result in minor or moderate injury.** It is also used to alert against unsafe practices and hazards involving property damage.

WARNING

Improper adjustment, service or maintenance may create a condition where the operation of the product could cause personal injury or property damage.

Refer to this manual for assistance or for additional information consult the Technical Support Group.

CAUTION

This product must be serviced and maintained as specified in these instructions and/or to any applicable local, state, and national codes including, but not limited to building, electrical, and mechanical codes.

WARNING

FIRE OR ELECTRICAL HAZARD

Failure to follow the safety warnings exactly could result in serious injury, death, or property damage.

A fire or electrical hazard may result causing property damage, personal injury or loss of life.

SAFETY REQUIREMENTS

1. The air handlers with electric heaters may have a dual electrical supply circuit. Make sure you check each electrical circuit with a meter to be sure the power has been disconnected.
2. Insulating materials may be combustible. The air handler must be kept free and clear of insulating materials.
3. Follow the instructions exactly as shown in Startup and Shutdown Section in this manual to properly Startup or Shutdown this appliance.
4. Make sure all moving parts have come to a complete stop before attempting to perform any work once the appliance door has been removed. Moving parts can cause serious injury if clothing or body parts get caught in the moving part.

WARNING

ELECTRICAL SHOCK, FIRE HAZARD

Failure to follow the safety warnings exactly or improper servicing could result in dangerous operation, serious injury, property damage, and/or death.

- Before servicing, disconnect all electrical power to the appliance. Make sure you disconnect both power supplies if the appliance has a dual power supply circuit. Dual circuits may be used on the 15kW and 20kW models.
- When servicing controls, label all wires prior to disconnecting to aid in proper reconnection of wires.
- Verify proper operation after servicing by turning the thermostat above the room temperature for a brief period of time to ensure proper appliance operation

WARNING

FIRE HAZARD

NEVER PLACE A JUMPER BETWEEN “R” & “W”

Placing jumper wire between the RED and WHITE thermostat wires at the air handler in order to override the thermostat and energize the heater elements is an extremely dangerous practice that can result in damage to the thermostat, dangerous operation, serious injury, property damage and/or death.

SECTION II: AIR HANDLER MAINTENANCE

The interior sections of the air handler must be cleaned and adjusted by a qualified service contractor once a year or before the start of each heating or cooling season. The following items must be checked:

1. The blower wheel and motor for excessive dirt.
2. The electrical components for excessive dust, dirt, wear, or deterioration.
3. The supply air duct system for excessive dust, dirt or debris
4. The return air duct system for excessive dust, dirt or debris
5. All electrical wiring for wear, insulation cracks and/or damage.
6. Check the air conditioning evaporator coil for dust, debris or damage.
7. Check the evaporator coil drain pan for proper drainage to prevent water backup into the unit.
8. The air handler casing and all interior sheet metal panels or dividers.

Air Handler Cleaning Procedure

1. Follow the instructions exactly as shown in Startup and Shutdown Section in this manual to properly shutdown this appliance.
2. Remove the upper access door on the front of the air handler.
3. Remove the lower access door on the front of the evaporator coil compartment.
4. ECM or X-13 Motors - Unplug the wire harnesses from the blower motor.
PSC Motor – Unplug the wires from the 6 pin plug at the bottom of the control box.
5. Remove the two screws on the left and right side and the center screw on the bracket in front of the blower mounting plate and slide the blower out. Refer to Figure 8.
6. Place a piece of cardboard on top of the evaporator coil to prevent dirt or debris from falling onto the coil. Use a vacuum cleaner and a small brush to remove any dirt and debris from the blower and evaporator coil compartments.
7. Check the evaporator condensate drain pan for any debris and ensure the pan is properly draining by pouring water into the drain to check it.

8. Remove any excess water that may have spilled from checking the evaporator condensate drain.
9. Check in the area above the blower compartment where the hydronic heat piping is located and remove any dust, dirt or debris. Be careful not to damage the heater piping or coil with the vacuum hose or the brush.

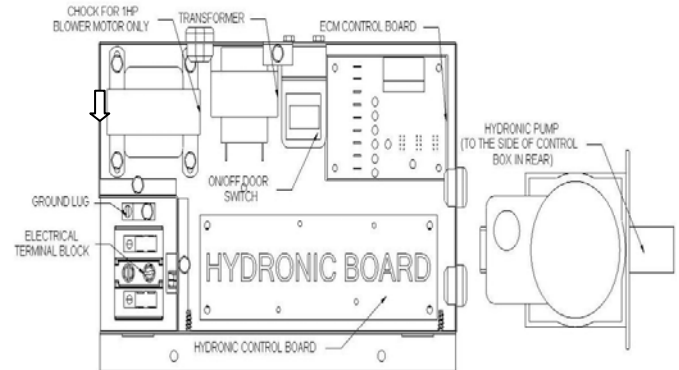

Figure 6: Hydronic Heat Control Box – with Pump

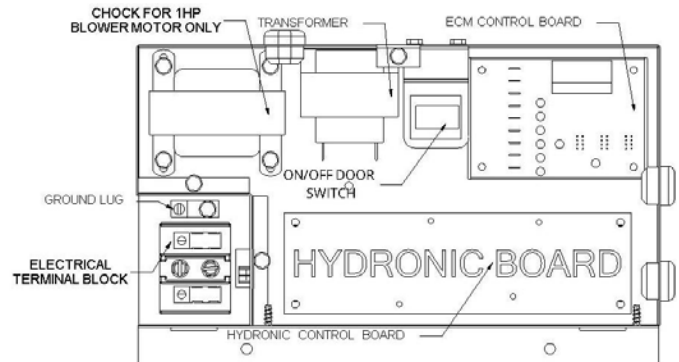

Figure 7: Hydronic Heat Control Box – No Pump

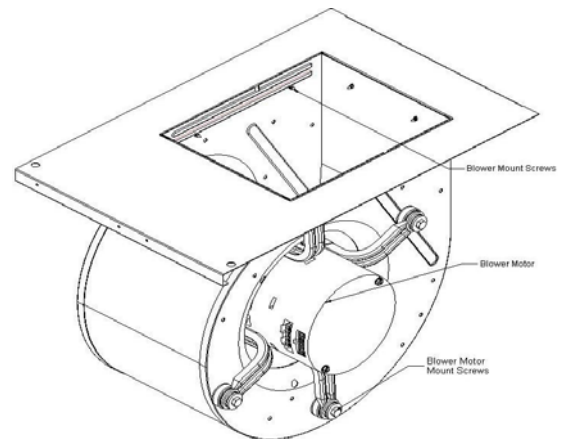

Figure 8: Blower Assembly and Mounting Screw Location

10. Check the blower wheel for dust and debris. Use the brush and the vacuum cleaner to remove any dust or debris from the wheel. Be careful not to move or accidentally remove the blower wheel balance weight located on the wheel blade. If it is moved or removed it will cause the blower wheel to vibrate. If the wheel is vibrating, you must replace it.
11. Check the blower motor for dust and debris. Be sure to clean the openings on the motor housing as these openings are used to cool the motor. If the dust, dirt or debris has not been removed from these openings it will

cause the motor to run hotter than normal and will shorten the life of the motor.

12. Check and clean with the brush and vacuum cleaner any dust in the supply and return ducts as far as you can reach. If these ducts look like they have an excessive amount of dust, dirt or debris you should recommend to the home owner or user to call a professional to properly clean the duct system.
13. Check and clean any dust, dirt, or debris from all of the controls and all of the surfaces in the control box. If dust or dirt is left on the components they will operate at a much hotter temperature causing premature component failure.
14. Reinstall the blower assembly and secure the assembly to the casing by using the screws that was removed in step 5.
15. Reinstall the lower access door on the front of the evaporator coil compartment.
16. Reinstall the upper access door on the air handler.
17. Follow the instructions exactly as shown in Startup and Shutdown Section in this manual to properly startup this appliance.

SECTION III: AIR HANDLER CONTROLS

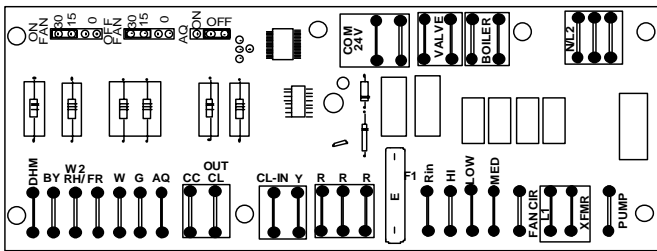

Figure 9: ICM AY1015 Hydronic Control Board for Constant Torque and ECM Motors

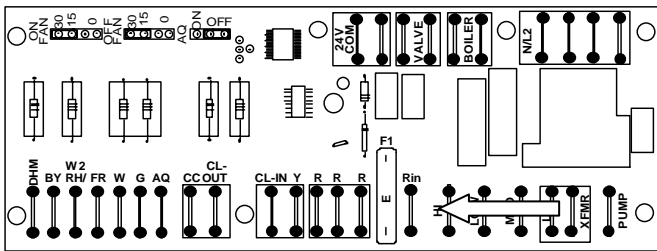

Figure 10: ICM AY1014 Hydronic Control Board for PSC Motors

Hydronic Heat Models

This section discusses the air handler controls and how they operate. Refer to Figure 10 for component locations.

1. **Transformer** – The transformer is used to step down voltage from 240 VAC to 24 VAC. The transformer provides the required 24 VAC for the system control circuit.
2. **Pump Relay** – This relay is not used on all hydronic models. This relay is a single pole single throw relay that energizes the water pump on a call for heat. The 24 VAC coil is connected to the thermostat “W” terminal. The coil is energized on a call for heat closing the normally open terminals sending 120 VAC thru the relay contacts to the water pump motor. Once the call for heat has been

satisfied, the 24 VAC is removed from the thermostat “W” terminal de-energizing the relay coil and opening the contacts to the water pump motor.

3. **PSC Blower Motor Isolation Relay** - This relay is a single pole double throw relay. Is required for isolation between the high and low speeds of a motor. The wiring has been designed so that the normally closed contacts are used for heating and the normally open contacts are used for cooling. The relay coil is energized after the thermostat has a call from the “G” terminal. The normally closed contacts on the isolation relay open and the normally open contacts close, energizing the motor on the selected cooling speed.
4. **ECM Motor Isolation Relay** - This relay is not used on the ECM motor has programmable heating and cooling blower time delays along with climate profile time delays. See climate profile section for more information.

SECTION IV: SEQUENCE OF OPERATION

Continuous Blower – Hydronic Heat Models

The thermostat has a manual fan switch that can be moved to the “On” position or it can be programmed for **continuous** fan operation. This setting causes the thermostat to complete the circuit between “R” and “G” terminals sending 24 VAC to the “G” terminal on the hydronic control board. The hydronic control board will energize the blower motor on the HI speed terminal.

The indoor blower will operate continuously until the fan switch on the thermostat has been switched from on to auto. When the thermostat is switched back to auto the blower will de-energize after the selected OFF time delay

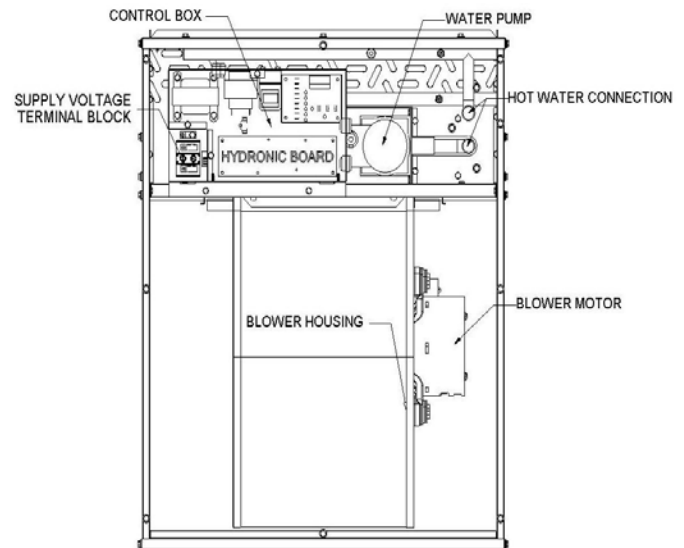

Figure 11: Component Locations – Hydronic Heat Models

Models

Intermittent Blower – Cooling

Hydronic Heat Models

The thermostat has a manual fan switch that can be moved to the “Auto” position or it can be programmed for **auto** fan operation. When the thermostat calls for cooling, a circuit is completed between the “R”, “Y” and “G” terminals sending

24 VAC to the hydronic control board thru the “Y” and “G” terminals. The blower motor will be energized on the HI speed terminal after the selected ON time delay. When the thermostat is satisfied the circuit between “R”, “Y” and “G” will open. The Hydronic control board will open the HI speed relay on the board and the PSC blower motor will turn off after the selected OFF time delay. The blower is now in the standby mode waiting for the next cooling cycle

The Motor Isolation Relay

This relay is used in conjunction with the motors to prevent the possibility of the motors being energized on two speed taps at the same time. This condition would burn out the motor windings.

PSC motor has a black wire is connected from the circuit breaker to the supply side of the normally open terminals on the relay. The blower motor high speed tap wire is connected to the load side (Terminal #4) normally open terminal on relay.

Constant Torque motor has a black wire that is connected from the “W” terminal #1 on the heat relay to the supply side (Terminal #2) of the normally open terminals on the isolation relay. The blower motor high speed tap wire is connected to the load side (Terminal #4) normally open terminal on relay.

PSC motor has a red wire is connected from the load side of the heat relay (Terminal # 4 or 6) to the normally closed terminal (Terminal #5) on the isolation relay. The load side (Terminal #6) of the normally closed terminal is connected to the low speed tap blower motor.

Constant Torque motor has a red wire is connected from the 24 VAC coil of the heat relay (Terminal #0) to the normally closed terminal (Terminal #5) on the isolation relay. The load side (Terminal #6) of the normally closed terminal is connected to the low speed tap blower motor.

ECM motors are connected and controlled by a ECM control board. The thermostat wires are connected to the thermostat terminals on the ECM control board. Isolation relay is not used with a ECM motor.

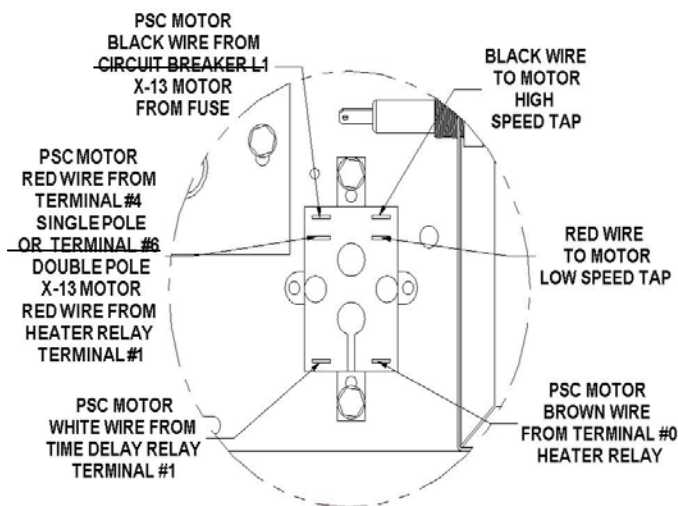

Figure 12: Motor Speed Tap Isolation Relay – Constant Torque and PSC Motors

WARNING

For personal safety be sure to turn the electrical power “OFF” at the main entrance (Circuit Breaker Box) and at the control box circuit breakers before attempting any service or maintenance operations. Home owners should never attempt to perform any maintenance which requires opening the air handler control box door.

SECTION V: TROUBLE SHOOTING

The following checks should be made before trouble shooting the air handler controls for a no heat issue.

1. Check all of the circuit breakers. Make sure they are turned to the “ON” position and have not tripped.
2. Check all fuses, especially any supply line fuses that were installed during installation. If the fuse is blown, check the wiring with an OHM meter for a short to ground. If shorted, repair the short, and then replace the fuse.
3. Check any electrical switches that are external to the furnace to make sure they are turned on.
4. Check all wiring connections, especially on any of the components, to ensure they are securely fastened.

Hydronic Heat Models

If you have hydronic heat you have a hydronic control board. There is 120 volts between the terminal block L1 and L2/N terminals and 120 VAC between the XFMR and L2/N terminals on the control board. There should also be 24 VAC on the “Rin” and “C” terminals on the control boards. Also check to make sure you have 24 volts between to the “R” terminal and “C” terminal on the control board. If you do have 24 VAC on “Rin” but do not on “R” check the fuse, if you do have 24 VAC on both then continue on through the rest of the checks.

PSC Motor Check – Hydronic Heat Models

If the motor is not running, check for 120 volts at the terminal block to determine if there is 120 volts to the unit then check the following items on the hydronic control board to determine if the blower motor is bad.

Heating Mode

If the thermostat “W” terminal is energized and there is 24 VAC on the “W” terminal on the hydronic control board check for 120 volts between the LOW terminal and the L2/N terminal. If the 120 volts is present at the hydronic control board LOW terminal but the motor is not operating, then replace the motor.

Cooling Mode

If the thermostat “G” terminal is energized and there is 24 VAC on the “G” terminal on the hydronic control board check for 120 volts between the HI terminal and the L2/N terminal. If the 120 volts is present at the hydronic control board HI terminal but the motor is not operating, then replace the motor.

ECM Motor Check – Hydronic Heat Models

If the motor is not running, check for 120 volts is present at the motor terminals and 24 volts is present at the ECM control board. If the 120 volts is present on L1 and L2/N on the Hydronic Control Board and 24 volts is present at the “R” and “C” terminals of the ECM Board and the motor is not

operating, then check the control board thermostat terminals to determine if 24 volts is present at “R” and “W”. If 24 VAC is present then proceed with the **16 Pin ECM Cable Test** below before replacing the ECM board or motor.

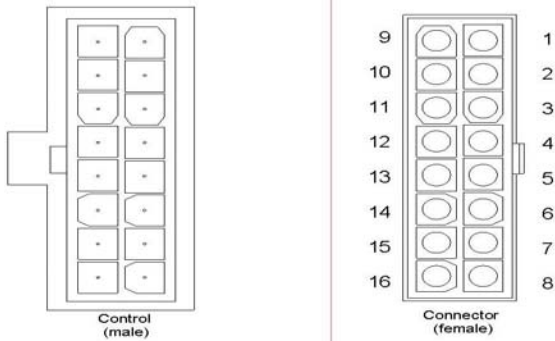

Figure 13: ECM Motor Control Pin out

Pin Number

- 1 Common C1
- 2 W/W1
- 3 Common C2
- 4 Delay Tap Select
- 5 Cool Tap Select
- 6 Y1
- 7 Adjust Tap Select
- 8 Output –
- 9 Reversing Valve (Heat Pump Only)
- 10 Humidistat (BK)
- 11 Heat Tap Select
- 12 24 VAC (R)
- 13 2nd Stage Heat (EM/W2)
- 14 2nd Stage Cool (Y/Y2)
- 15 Fan (G)
- 16 Output +

16 Pin ECM Cable Test

NOTE: Volt meter will not read between pins 4, 5, 7, 11 and 1 or 3 because these signals are not full wave signals.

To verify ECM board is functioning properly in the heating mode check for 24 volts between pins 1 and 2.

To verify ECM board is functioning properly in the cooling

PSC Motor Check – AY1014 Hydronic Heat Models

If the motor is not running, check for 120 volts at the hydronic control boards speed tap terminal and the L2/N terminal. If the 120 volts is present but the motor is not operating, then replace the motor.

Heating Mode

If the thermostat “W” terminal is energized and there is 24 VAC on the “W” terminal on the hydronic control board check for 120 volts between the LOW terminal and the L2/N terminal. If the 120 volts is present between the hydronic control board LOW terminal and the L2/N terminal but the motor is not operating, then replace the motor.

Cooling Mode

If the thermostat “G” terminal is energized and there is 24 VAC on the “G” terminal on the hydronic control board. Check for 120 volts between the HI terminal and the L2/N terminal. If the 120 volts is present but the motor is not operating, then replace the motor.

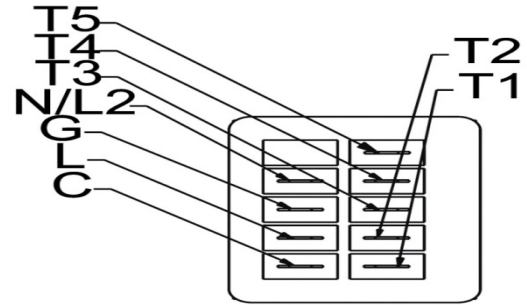

Figure 14: X-13 Motor Terminals

WARNING

To avoid personal injury or property damage, make certain that the motor leads cannot come into contact with non-insulated metal components of the unit.

Terminal	Connection
C	Speed Tap Common - 24 VAC Common
L	Supply Voltage - 240 Vac Line 1
G	Ground Connection
N/L2	Supply Voltage - 240 Vac Line 2
1	Low Speed Tap - 24 VAC Input
2	Medium-Low Speed Tap - 24 VAC Input
3	Medium Speed Tap - 24 VAC Input
4	Medium-High Speed Tap - 24 VAC Input
5	High Speed Tap - 24 VAC Input

Table 1: X-13 Motor Terminal Connections

Constant Torque Motor Check – AY1015 Hydronic Heat Models

If the motor is not running, check for 120 volts at the hydronic control boards speed tap terminal and the L2/N terminal. If the 120 volts is present but the motor is not operating, then check the heating and cooling modes.

Heating Mode

If the thermostat “W” terminal is energized and there is 24 VAC on the “W” terminal on the hydronic control board check for 24 volts between the LOW terminal and the COM terminal. If the 24 volts is present between the hydronic control board LOW terminal and the COM terminal but the motor is not operating, then replace the motor.

Cooling Mode

If the thermostat “G” terminal is energized and there is 24 VAC on the “G” terminal on the hydronic control board. Check for 24 volts between the HI terminal and the COM terminal. If the 24 volts is present but the motor is not operating, then replace the motor.

HP	ECM	X-13	PSC
1/3	0.78	0.72	2.00
1/2	2.00	1.66	3.00
3/4	2.50	2.09	3.60
1.0	3.75	5.72	

Table 2: 208 / 240 Volt Blower Motor FLA

HP	ECM	X-13	PSC
1/3	1.80	2.72	4.40
1/2	2.31	2.72	7.70
3/4	6.31	5.71	11.00
1.0	8.48	8.48	

Table 3: 120 Volt Blower Motor FLA

Replacing the Blower

1. Follow the instructions exactly as shown in Startup and Shutdown Section in this manual to properly shutdown this appliance.
2. Remove the upper access door on the front of the air handler.
3. Remove the lower access door on the front of the evaporator coil compartment.
4. ECM or X-13 Motors - Unplug the wire harnesses from the blower motor.
PSC Motor – Unplug the wires from the 6 pin plug at the bottom of the control box.
5. Remove the two screws on the left and right side and the center screw on the bracket in front of the blower mounting plate and slide the blower out.
6. Reinstall the blower assembly and secure the assembly to the casing by using the bracket and screws that were removed in step 5.
7. Reinstall the lower access door on the front of the evaporator coil compartment.
8. Reinstall the upper access door on the air handler.
9. Follow the instructions exactly as shown in Startup and Shutdown Section in this manual to properly startup this appliance.
10. Set the thermostat above the room temperature so the unit will operate and you can observe the appliance startup to ensure the appliance is operating correctly.
11. After proper operation has been observed and documented, set the thermostat to the desired temperature.

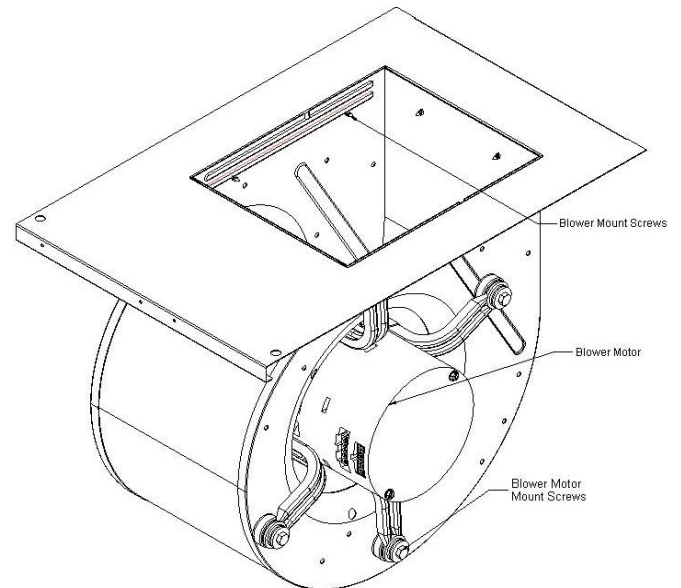

Figure 15: Blower Mounting Plate Screw Locations

▲WARNING

To avoid personal injury take precautions not come into contact with non-insulated electrical components.

Avoid wearing loose clothing or any items that can come in contact with moving parts, such as the blower wheel. This can cause serious personal injury

SECTION VI: BLOWER PERFORMANCE

Model Number	Motor HP	Volts 1 Ph. 50/60 Hz.	Motor Code	Blower Wheel	Jumper	CFM @ 0.10"	CFM @ 0.20"	CFM @ 0.30"	CFM @ 0.40"	CFM @ 0.50"
MMVEOS	0.33	120	VG	10 x 7	A	884	884	884	880	880
					B	799	792	789	789	789
					C	691	691	691	691	690
					D	589	589	589	589	584
MMVEOM	0.50	120	VH	10 x 7	A	1294	1255	1200	1137	1058
					B	1131	1104	1075	1082	1023
					C	974	942	909	853	831
					D	808	769	736	702	657
MMVEOL	1.00	120	VI	12 x 9	A	2001	1994	1994	1987	1972
					B	1820	1820	1820	1804	1796
					C	1587	1599	1604	1604	1604
					D	1385	1385	1385	1385	1385

Table 4: MMVE Blower Performance Chart – CFM Data with a Constant Air Flow Motor -Without Air Filters

Model Number	Motor HP	Volts 1 Ph. 50/60 Hz.	Motor Code	Blower Wheel	Jumper	AMPS @ 0.10"	AMPS @ 0.20"	AMPS @ 0.30"	AMPS @ 0.40"	AMPS @ 0.50"
MMVEOS	0.33	120	VG	10 x 7	A	3.120	3.470	3.730	4.060	4.370
					B	2.440	2.710	2.950	3.240	3.620
					C	1.760	2.090	2.400	2.690	2.910
					D	1.270	1.530	1.810	2.090	2.310
MMVEOM	0.50	120	VH	10 x 7	A	3.700	3.800	3.700	3.500	3.400
					B	2.700	2.800	3.000	3.100	3.200
					C	1.900	2.000	2.100	2.100	2.300
					D	1.200	1.300	1.500	1.600	1.700
MMVEOL	1.00	120	VI	12 x 9	A	6.200	6.400	6.690	7.110	6.310
					B	4.970	5.130	5.320	5.510	5.650
					C	3.540	3.750	3.860	4.120	4.330
					D	2.580	2.720	2.850	3.070	3.290

Table 5: MMVE Blower Performance Chart – Amp Data with a Constant Air Flow Motor -Without Air Filters

Model Number	Motor HP	Volts 1 Ph. 50/60 Hz.	Motor Code	Blower Wheel	Motor Tap	CFM @ 0.10"	CFM @ 0.20"	CFM @ 0.30"	CFM @ 0.40"	CFM @ 0.50"
MMVTOS	0.33	120	VG	9 x 6	1	693	667	657	618	598
					2	753	745	711	693	675
					3	785	753	745	720	702
					4	838	816	808	777	753
					5	874	860	846	816	769
MMVTOM	0.50	120	VH	10 x 7	1	714	668	639	587	517
					2	874	845	806	782	732
					3	1082	1046	1015	983	951
					4	1156	1122	1094	1065	1028
					5	1313	1262	1226	1156	1077
MMVTOL	1.00	120	VI	12 x 9	1	1479	1448	1416	1373	1341
					2	1558	1529	1499	1459	1438
					3	1641	1614	1596	1548	1510
					4	1783	1749	1723	1670	1625
					5	1935	1879	1764	1764	1694

Table 6: MMVT Blower Performance Chart – CFM Data with a Constant Torque Motor -Without Air Filters

Model Number	Motor HP	Volts 1 Ph. 50/60 Hz.	Motor Code	Blower Wheel	Motor Tap	AMPS @ 0.10"	AMPS @ 0.20"	AMPS @ 0.30"	AMPS @ 0.40"	AMPS @ 0.50"
MMVTOS	0.33	120	VG	10 x 7	1	0.900	0.900	1.000	1.100	1.200
					2	1.100	1.200	1.200	1.200	1.300
					3	1.200	1.200	1.300	1.300	1.310
					4	1.400	1.400	1.500	1.510	1.600
					5	1.600	1.700	1.700	1.710	1.800
MMVTOM	0.50	120	VH	10 x 7	1	1.500	1.500	1.600	1.700	1.710
					2	2.300	2.400	2.400	2.410	2.410
					3	2.600	2.600	2.600	2.610	2.620
					4	2.600	2.600	2.610	2.620	2.630
					5	2.700	2.700	2.710	2.710	2.720
MMVTOL	1.00	120	VI	12 x 9	1	2.920	2.970	3.060	3.140	3.250
					2	3.440	3.480	3.590	3.660	3.740
					3	3.950	4.050	4.120	4.210	4.270
					4	5.050	5.120	5.180	5.240	5.270
					5	6.830	6.580	6.260	5.990	5.710

Table 7: MMVT Blower Performance Chart – Amp Data with a Constant Torque Motor -Without Air Filters

Model Number	Motor HP	Volts 1 Ph. 50/60 Hz.	Motor Code	Blower Wheel	Motor Tap	CFM @ 0.10"	CFM @ 0.20"	CFM @ 0.30"	CFM @ 0.40"	CFM @ 0.50"
MMPSOS	0.33	120	VG	9 x 6	Low	772	731	683	635	569
					Medium	815	764	718	665	598
					High	836	791	739	678	612
MMPSOM	0.50	120	VH	10 x 7	Low	930	956	969	950	917
					Medium	1206	1190	1154	1105	1043
					High	1412	1355	1281	1217	1139
MMPSOL	0.75	120	VI	12 x 9	Low	1091	1087	1084	1078	1051
					Medium	1456	1446	1446	1446	1426
					High	2231	2171	2103	2040	1989

Table 8: MMPS Blower Performance Chart – CFM Data with a PSC Motor -Without Air Filters

Model Number	Motor HP	Volts 1 Ph. 50/60 Hz.	Motor Code	Blower Wheel	Motor Tap	AMPS @ 0.10"	AMPS @ 0.20"	AMPS @ 0.30"	AMPS @ 0.40"	AMPS @ 0.50"
MMPSOS	0.33	120	VG	10 x 7	Low	2.80	2.60	2.50	2.30	2.20
					Medium	3.10	2.90	2.80	2.70	2.50
					High	3.70	3.60	3.50	3.40	3.30
MMPSOM	0.50	120	VH	10 x 7	Low	5.90	5.30	5.14	4.70	4.30
					Medium	6.50	5.90	5.50	5.10	4.70
					High	6.70	6.30	6.00	5.70	5.40
MMPSOL	1.00	120	VI	12 x 9	Low	7.60	7.30	7.00	6.90	6.50
					Medium	9.80	9.30	8.90	8.70	8.20
					High	13.40	12.90	12.60	12.10	11.90

Table 9: MMPS Blower Performance Chart – Amp Data with a PSC Motor -Without Air Filters

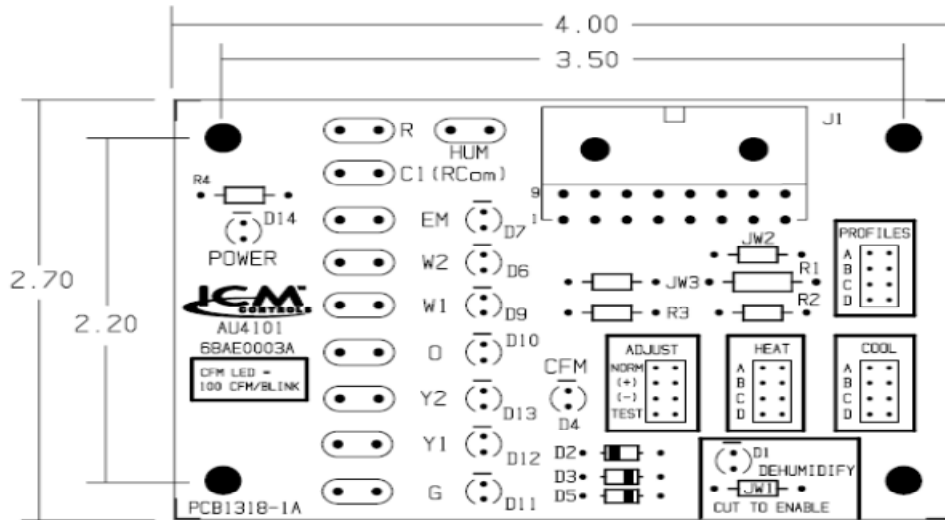

Figure 16 ECM Control Board Diagrams

Blower Performance Data - Variable Speed (High Efficiency) Constant Air Flow Motor																
Model Number	Operating Mode	Thermostat Terminals							Control Board Taps							
		v = Energized Terminals							Cool				Heat			
		Y1	Y2	W1	W2	EM	G	HUM	A	B	C	D	A	B	C	D
		CFM	CFM	CFM	CFM	CFM	CFM	CFM	CFM	CFM	CFM	CFM	CFM	CFM	CFM	CFM
MMVEOS	Hi Cooling / HP Heating	v	v					++	1000	900	800	700				
	Low Cooling / HP Heating	v							850	750	700	610				
	Auxiliary Heat	v	v	v					+++	+++	+++	+++	1000	900	800	700
	Emergency Heat					v			+++	+++	+++	+++	1000	900	800	700
	Continuous Blower						v		500	450	400	350				
MMVEOM	Hi Cooling / HP Heating	v	v					++	1600	1400	1200	1100				
	Low Cooling / HP Heating	v		v					1500	1300	1100	1050				
	Auxiliary Heat	v	v	v					+++	+++	+++	+++	1600	1400	1200	1100
	Emergency Heat					v			+++	+++	+++	+++	1300	1175	1000	960
	Continuous Blower						v		800	700	600	550				
MMVEOL	Hi Cooling / HP Heating	v	v					++	2100	1700	1500	1490				
	Low Cooling / HP Heating	v		v					2000	1600	1450	1350				
	Auxiliary Heat	v	v	v					+++	+++	+++	+++	2100	1700	1500	1490
	Emergency Heat					v			+++	+++	+++	+++	1800	1585	1485	1485
	Continuous Blower						v		1050	850	750	745				

Table 10: Constant Air Flow Blower - ECM Control Board Tap Selections

“+++” When auxiliary heat and heat pump are activated the airflow will increase to the higher CFM selected by the “HEAT” or “COOL” jumper pin on the ECM Board.

The “COOL” jumper pins select the CFM for both cooling or heat pump operation. Heat Pump and Cooling use different CFM Tables.

“++” Remove 24 VAC signal to “HUM” terminal by cutting the dehumidify resistor. This will cause the motor CFM to be reduced by 30%. Humidistat must be programmable to remove signal to “HUM” terminal on humidity rise. (Refer to Figure 1)

Adjust tap “+” increases airflow by 10%.

Adjust tap “-“ reduces airflow by 12%.

Adjust tap “TEST - The motor is programmed to ignore the “TEST” pin. This prevents field service personnel from leaving the jumper pin in the “TEST” mode.

“PROFILES” – Climate Profiles are used to ramp up to the selected CFM and ramp the motor down to 0 CFM depending on the climate you are residing. Refer to the Climate Profiles drawings, Figures 1 and 2 to determine what profile is best profile for your area, then, change the jumper pin under PROFILES to select the A, B, C or D profile. The Climate Profiles are the same for Cooling and Heat Pump. Profiles “E” for Electric Heat and “F” for Emergency Heat are programmed settings and are not field adjustable. Refer to Figure 2 “Electric w/ Element On and/or Off Delays” for the “E” and “F” profile.

PWM – Pulse Width Modulation – The blower motor must be returned to the factory to be reprogrammed in order to be operated in the PWM mode. It is recommended the air handler be ordered for PWM operation.

SECTION VII: ECM 2.3 CLIMATE PROFILES

Background

The GE ECM 2.3 motor has an extensive array of programmable features for varying airflow as a function of time. These options are beneficial to enhance comfort and efficiency in furnaces, air conditioners and heat pumps. The options are called “Delay Profiles” and “Slew Rates” and are created by OEM Design Engineers using the ECM programming software.

The delay profiles can be adjusted in the installation to optimize comfort. The ECM 2.3 supports five field selectable profiles that can be used for heating or cooling. We recommend programming the motor to use 1 heating and 4 cooling profiles. Each profile, which represents one complete thermostat cycle, has 4 unique components called PreRun, Short Run, Full Capacity, and Off Delay. In the field, profiles are selected by moving a jumper or dip switch setting. Slew rates are preprogrammed in the control memory, and are not field adjustable.

Cooling Profiles (refer to Fig. 1)

These profiles are used to provide dehumidification and improve system efficiency.

PreRun allows for a reduced airflow capacity at compressor startup (“On” in the profile diagrams). In humid climates where dehumidification is highly desired, a reduced percentage of the maximum CFM can be selected to allow more moisture to collect and then drain from the coils.

The Short Run CFM and time can be selected to achieve various degrees of dehumidification and reduce re-evaporation. In more arid or moderate climates, these values are modified to achieve full capacity cooling in a shorter time period.

The Off Delay is intended to allow the blower to run for a period of time after the compressor shuts off. In arid and moderate climates this feature will evaporate moisture back into the air.

In humid climates this time is programmed to zero to minimize re-evaporation of evaporator coil and drain pan moisture back into the conditioned space.

Heating Profiles (refer to Fig 2.)

These profiles are used to provide a high degree of comfort and to improve system efficiency. There are a variety of profiles available to accommodate most popular heating technologies. It may be desirable for a **gas** or **oil furnace** to have a short PreRun delay at very low airflow until the heat exchanger is up to an adequate temperature. At the end of the heating cycle, an Off delay can be used to improve system efficiency by continuing to move air across the exchanger until the residual heat is removed. In the case of **electric heat**, a rapid On slew rate to full capacity is used to prevent overheating of the coils. Likewise, a rapid Off slew rate will prevent blowing cool air into the home after the heating coils have shut off. If thermal relays are used to control the heating coils or if coils are staged, then the On slew, PreRun heating, and Off slew can be set at different rates to match relay performance.

Unique requirements of **heat pumps** can also be accommodated by matching delays to individual system performance characteristics. An emergency or backup profile can also be created to match system response to a call for secondary heat in the heat pump application.

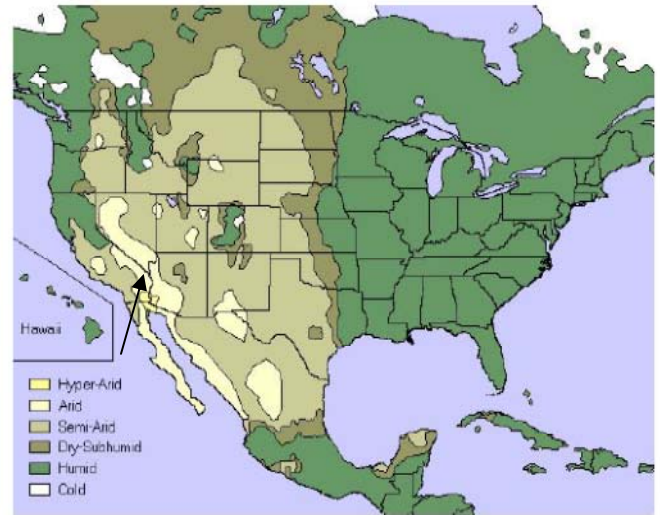

NOTE: Cold area is shaded in white in Canada only.

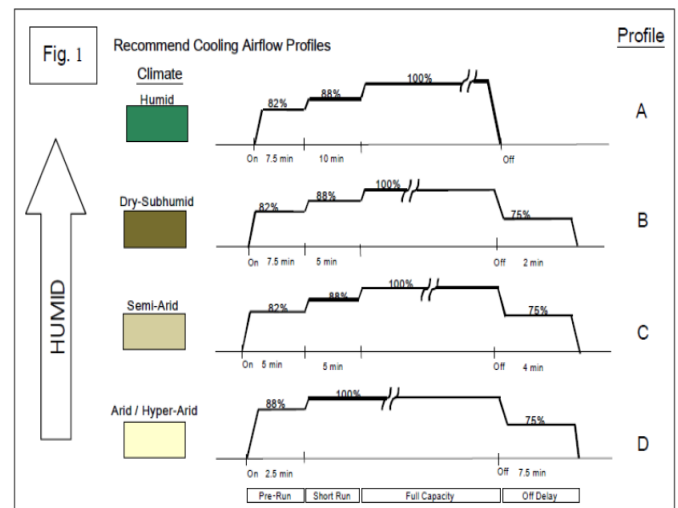

Figure 17: ECM Climate Profiles Chart

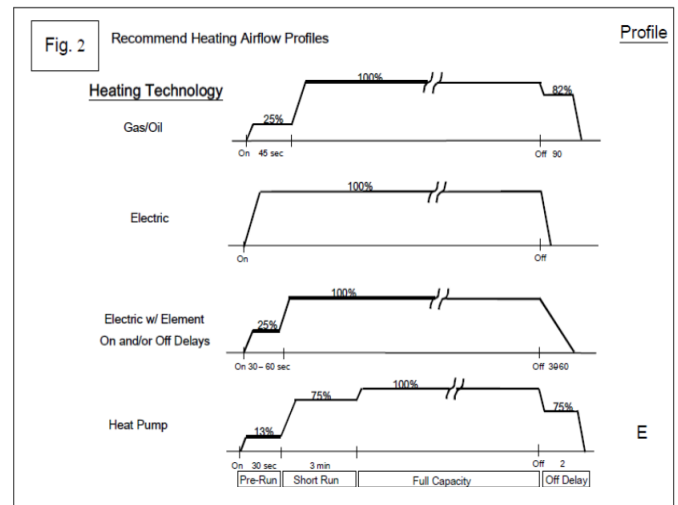

Figure 18: ECM Climate Profile

SECTION VIII: ACCESSORY AND REPLACEMENT PARTS LISTS

MMVE / MMVT / MMPS	
Part Number	Part Description
86MDS003	Accessory 16 x 20 x 2 Filter Base Kit

Table 11: Accessory Parts List

SECTION IX: REPLACEMENT PARTS LISTS

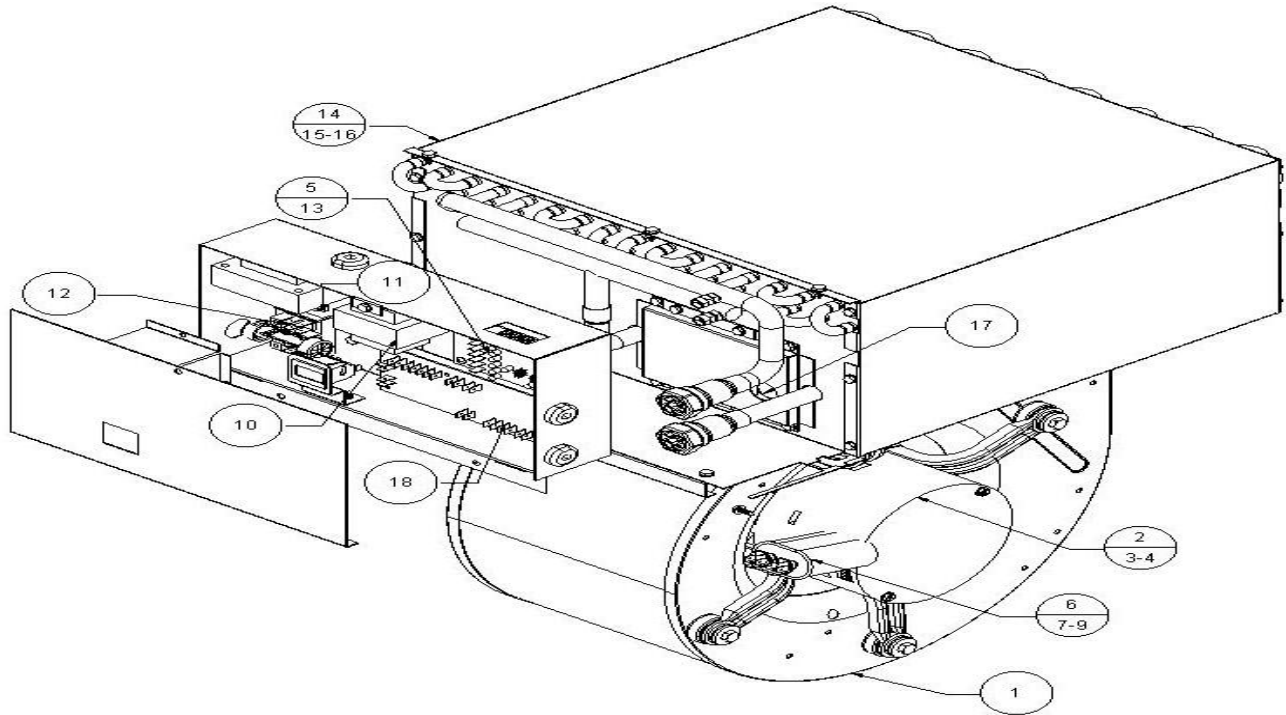

Figure 19: MM**OS Hydronic Heat Air Handler Repair Parts Schematic

MM**OS Hydronic Heating			
Item No.	Q!ty	Part Number	Description
1	1	R69AD0002	10 X 7 Blower Assembly - MMVEOS Only
1	1	R69AD0001	9 x 6 Blower Assembly - MMVTOS and MMPSOS
2	1	R65BV0001	1/3 HP 120 VAC Constant Air Flow Blower Motor
2	1	R65BV0021	1/3 HP 120 VAC Constant Torque Blower Motor
2	1	R65BU0162	1/3 HP 120 VAC PSC Blower Motor
3	1	R69AC0001	9 x 6 Blower Wheel 1/2" CW - MMVEOS ONLY
3	1	R69AC0002	10 x 7 Blower Wheel 1/2" CW - MMVTOS and MMPSOS
4	1	R68AE0003	Constant Air Flow Motor - ECM Control Board - MMVE Only
5	1	R68DE0003	5 MFD/370VAC Capacitor
6	1	R68AA0002	120 VAC to 24 VAC Transformer
7	1	R68DC0001	Ground Lug
8	1	R68DC0018	Power Terminal Block
9	1	R68AE0010	ICM AY1014 Hydronic Control Board - MMPS
9	1	R68AE0010	ICM AY1015 Hydronic Control Board - MMVE and MMVT
10	1	R68DD0012	Safety Disconnect Switch
11	1	R86CH0017	2 Row Hydronic Coil 14.75 x 16
11	1	R86CH0018	3 Row Hydronic Coil 14.75 x 16
11	1	R86CH0025	4 Row Hydronic Coil 14.75 x 16
12	1	R68DC0045	3 Amp Automotive Blade Fuse - Located on Hydronic Control Board
13	1	R78AA0007	4 GPM Pumo 120 VAC
14	1	R68DD0005	White Wire Freeze Protector
15	1	R68DD0006	Yellow Wire Compressor Lockout Switch
16	1	R66AB0005	Sensor Clip HW/AH
17	1	R74BA0004	Valve - Air Bleed Body
18	1	R74BA0005	Valve - Air Bleed Core
19	1	R74BB0001	1/2" Boiler Drain

Table 12: MM**OS Hydronic Heat Air Handler Repair Parts List

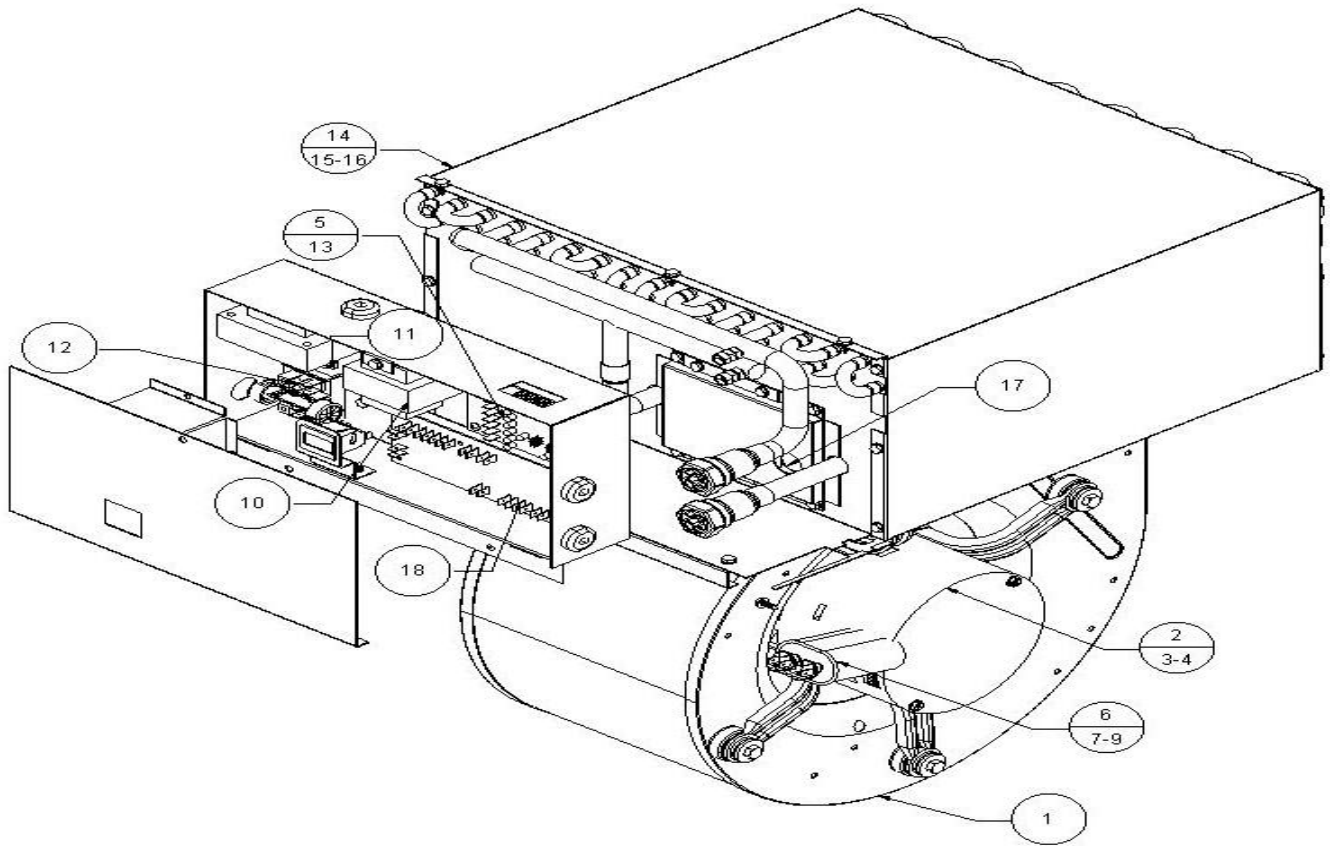

Figure 20: MM**OM Hydronic Heat Air Handler Repair Parts Schematic

MM**OM Hydronic Heating			
Item No.	Q!ty	Part Number	Description
1	1	R69AD0002	10 X 7 Blower Assembly
2	1	R65BV0002	1/2 HP 120 VAC Constant Air Flow Blower Motor
2	1	R65BV0022	1/2 HP 120 VAC Constant Torque Blower Motor
2	1	R65BU0163	1/2 HP 120 VAC PSC Blower Motor
3	1	R69AC0002	10 x 7 Blower Wheel 1/2" CW
4	1	R66AB0009	Motor Mount Band - 1/2 HP Motor
5	3	R66AB0010	Motor Mount Arm and Grommet - 1/2 HP Motor
6	4	R66CA0002	Screw 1/4-20 x 1.25" Hex Head - 1/2 HP Motor
7	1	R66CA0001	1/4-20 Nut - 1/2 HP Motor
8	1	R66CC0001	1/4 x 5/8 Washer for Motor Mount Arms - 1/2 HP Motor
9	1	R68AE0003	Constant Air Flow Motor - ECM Control Board - MMVE Only
10	1	R68DE0001	10 MFD/370VAC Capacitor
11	1	R68AA0002	120 VAC to 24 VAC Transformer
12	1	R68DC0001	Ground Lug
13	1	R68DC0018	Power Terminal Block
14	1	R68AE0010	ICM AY1014 Hydronic Control Board - MMPS
14	1	R68AE0010	ICM AY1015 Hydronic Control Board - MMVE and MMVT
15	1	R68DD0012	Safety Disconnect Switch
16	1	R86CH0019	2 Row Hydronic Coil 14.75 x 20
16	1	R86CH0020	3 Row Hydronic Coil 14.75 x 20
16	1	R86CH0021	4 Row Hydronic Coil 14.75 x 20
17	1	R68DC0045	3 Amp Automotive Blade Fuse - Located on Hydronic Control Board
18	1	R78AA0007	4 GPM Pumo 120 VAC
19	1	R68DD0005	White Wire Freeze Protector
20	1	R68DD0006	Yellow Wire Compressor Lockout Switch
21	1	R66AB0005	Sensor Clip HW/AH
22	1	R74BA0004	Valve - Air Bleed Body
23	1	R74BA0005	Valve - Air Bleed Core
24	1	R74BB0001	1/2" Boiler Drain

Table 13: MM**OM Hydronic Heat Air Handler Repair Parts List

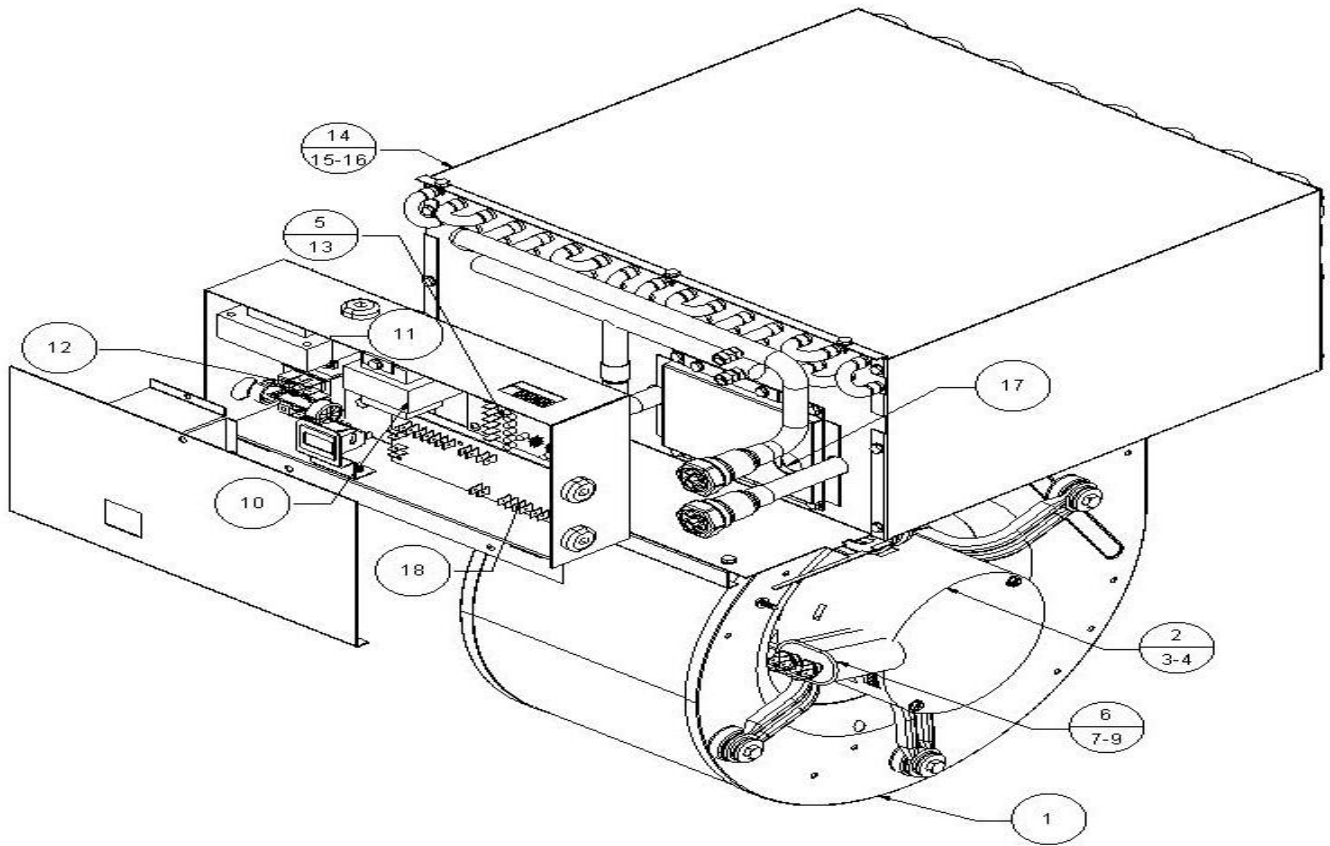

Figure 21: MM 37-42-48-60 Hydronic Heat Air Handler Repair Parts Schematic

MM**OL Hydronic Heating			
Item No.	Q!ty	Part Number	Description
1	1	R69AD0017	12 X 9 Blower Assembly
2	1	R65BV0004	1.0 HP 120 VAC Constant Air Flow Blower Motor
2	1	R65BV0024	1.0 HP 120 VAC Constant Torque Blower Motor
2	1	R65BU0165	1.0 HP 120 VAC PSC Blower Motor
3			12 x 9 Blower Wheel Is Not Sold Separately
4	1	R66AB0009	Motor Mount Band - 1.0 HP Motor
5	3	R66AB0010	Motor Mount Arm and Grommet - 1.0 HP Motor
6	4	R66CA0002	Screw 1/4-20 x 1.25" Hex Head - 1.0 HP Motor
7	1	R66CA0001	1/4-20 Nut - 1.0 HP Motor
8	1	R66CC0001	1/4 x 5/8 Washer for Motor Mount Arms - 1.0 HP Motor
9	1	R68AE0003	Constant Air Flow Motor - ECM Control Board - MMVE Only
10	1	R68DE0004	25 MFD / 370VAC Capacitor
11	1	R68AA0002	120 VAC to 24 VAC Transformer
12	1	R68DC0001	Ground Lug
13	1	R68DC0018	Power Terminal Block
14	1	R68AE0010	ICM AY1014 Hydronic Control Board - MMPS
14	1	R68AE0010	ICM AY1015 Hydronic Control Board - MMVE and MMVT
15	1	R68DD0012	Safety Disconnect Switch
16	1	R86CH0022	2 Row Hydronic Coil 15.75 x 24
16	1	R86CH0023	3 Row Hydronic Coil 15.75 x 24
16	1	R86CH0024	4 Row Hydronic Coil 15.75 x 24
17	1	R68DC0045	3 Amp Automotive Blade Fuse - Located on Hydronic Control Board
18	1	R78AA0007	4 GPM Pumo 120 VAC
19	1	R68DD0005	White Wire Freeze Protector
20	1	R68DD0006	Yellow Wire Compressor Lockout Switch
21	1	R66AB0005	Sensor Clip HW/AH
22	1	R74BA0004	Valve - Air Bleed Body
23	1	R74BA0005	Valve - Air Bleed Core
24	1	R74BB0001	1/2" Boiler Drain

Table 14: MS 37-42-48-60-72 Hydronic Heat Air Handler Repair Parts List